

## RLV49VR

This sensor offers a fixed focus v-arrangement in a very small metallic housing. The tiny overall dimensions allow to mount the sensor under extremely limited space conditions.

The background suppression is arranged in a way that even mirroring materials do not give any signal from a distance of more than 60mm from the sensor's face. In contrast to a triangulation approach this sensor is suitable even with transparent objects.

This product was originally design to detect different types and colors of paper. As well as glass.

For correct operation, a separate amplifier is required.



### Technical Sensor Data

Light Type	visible red 660 nm
Connection Type	1m PUR cable with M8 plug
Temperature Range	-10 to 55°C
Protection Class	IP65
Spot Ø	approx. 1 mm (in 10mm)

### Technical Data\*

		Standard Resolution	High Resolution
RLV49VR	Sensing Distance**	0...20 mm	4...6 mm
	Sensing Distance***	3...10 mm	-
	Background suppressed	> 60 mm	> 40 mm

\* maximum value with referring amplifier setting

\*\* on 50 x 50 mm white KODAK card

\*\*\* on 50 x 50 mm black carton

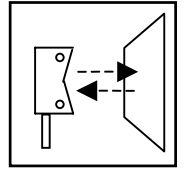

MECHANICAL DIMENSIONS [mm]

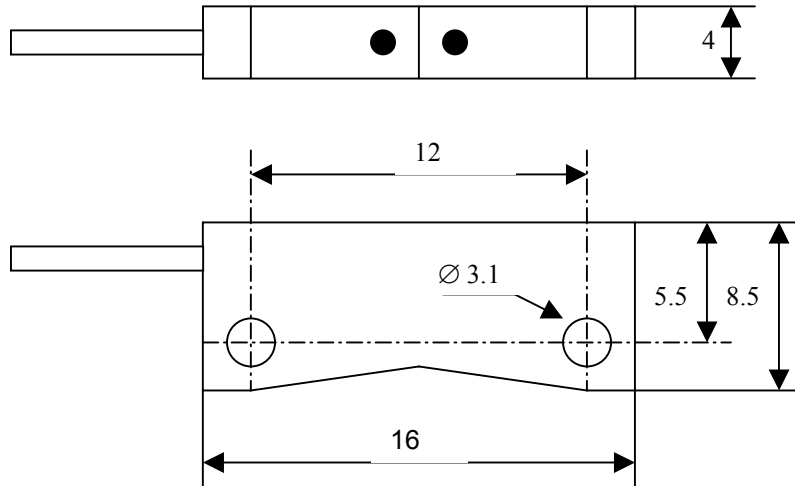

engineering changes reserved

PART DESIGNATION

In the standard configuration, we supply all systems with a Binder connector, series 768.

Vacuum suitable versions on request.

Sensor

RLV49VR